

PASADENA INTERMEDIATE

Student Information

STARTING AT PASADENA 2024



NAU MAI, WELCOME TO PASADENA

MY CLASS DETAILS FOR 2024

My teacher's name is: _____

I am in Room: _____

My teacher's email address is:

_____ @pasadena.school.nz

AT PASADENA, WE SHOW OUR VALUES

PROUD
ACTIVE
SAFE
ACHIEVER

YOUR FIRST DAY AT PASA

WEDNESDAY 31ST JANUARY 2024

When does school start and finish on the first day?

On Wednesday 31st January there will be a pōwhiri at 8am in the School Hall. School will start at 9am and finish at 3.00pm.

What should I wear?

The correct school uniform. School uniform needs to be worn to and from school. Please also bring your P.E gear and a school hat.

What should I bring?

Your stationery box if you have one otherwise a pen and paper, a drink bottle and your lunch.

Where do I go?

Head straight to your classroom. If you are unsure which classroom you are in, there will be staff available to help you.

Can I bring my phone?

Yes, however phones are collected each morning by your teacher, put in a box and stored safely at the office. It is returned to you each afternoon before the bell is rung. There is no phone use during the school day. If you need to contact your family you can come up to the school office.

Parents

Parents are invited to attend the 8.00am pōwhiri. From 8.30am parents are invited to the staffroom to have a cup of tea and meet key staff and other parents.

Usual School hours

Monday to Thursday 8.45am - 3.00pm
Friday 9.00am - 3.00pm

Students are asked not to arrive before 8:00am, unless involved in an official school activity with a teacher, and are asked to leave the grounds by 3:20pm.

Timetable

Block 1: 8.45am - 10.05am
Interval: 10.05am - 10.25am
Block 2: 10.25am - 11.35am
Lunch Eating: 11.35am - 11.50am
Block 3: 11.50am - 1.00pm
Recreation: 1.00pm - 1.45pm
Block 4: 1.45pm - 3.00pm

School communication

Pasadena communicates with parents in a variety of ways.

Email office@pasadena.school.nz

Website www.pasadena.school.nz

School App, this can be downloaded at <https://pasadenaint.apps.school.nz/share/>

Our school newsletter is emailed out every 3 weeks, and we also share information on our Facebook page.



SCHOOL MAP

Map 2024

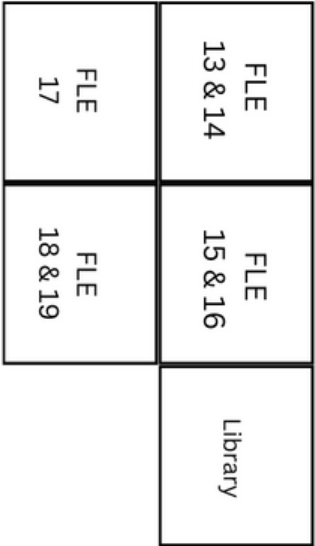

Rm 3: Emma Cornwell
 Rm 4: Marie Satele
 Rm 5: Charlotte Asi-Marsters
 Rm 6: Carly Honey
 Rm 7: Talia Rissling
 Rm 8: Ella Bartholomew
 Rm 11: Keith Ward
 Rm 12: Jerome Brown

Rm 13: Amanda Kemp
 Rm 14: Darcy-Lee Mitchell
 Rm 15: Alicia King
 Rm 16: Dylan Wiggill
 Rm 17: Te Aotahi Ngata-Aerengamate
 Rm 18: Keeghan Heihe
 Rm 19: Piripi Cotter

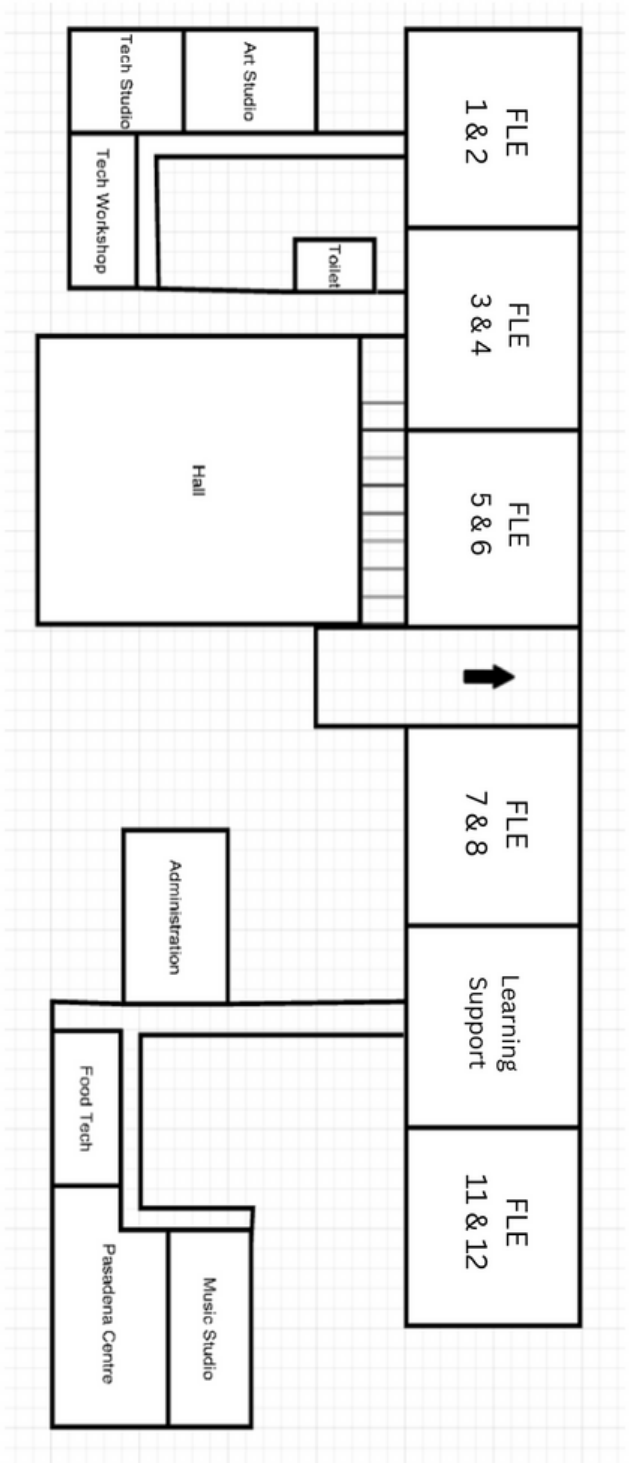

SCHOOL UNIFORM

In 2024, school uniforms can be purchased from our online shop, which can be accessed from our school website or at <https://pasadena.nzuniforms.com>

Uniforms can be tried on for sizing in the School Hall from **Tuesday 23 January to Friday 26 January, and Tuesday 30 January from 9.00 am – 1.00 pm.**

From Wednesday 31 January normal school hours apply, and they will be available to try on at the office.

Stationery boxes (\$40.00) can be purchased directly from the School Hall during these hours.

If you require help with navigating our online store, there will be devices and staff available at school to support you with this.



HOW TO ORDER YOUR SCHOOL UNIFORM ONLINE

Click on the link 'Buy your uniform online' on our school website

www.pasadena.school.nz

Unsure what size to order? A full size set is available to try on at school

Choose delivery to your home or work address, or 'click & collect' from the school office during term time

PAYMENT OPTIONS

We accept all major credit and debit cards and part-payment through ZIP. We also offer the 'Uniform Club', a great way to save for your school uniform purchases. Visit nzuniforms.com to join.

NAME LABELS

We can add a name label to the inside of each uniform item. Name labels last up to 300 washes. Add to your order online.



SCHOOL UNIFORM

All uniform items can be bought from <https://pasadena.nzuniforms.com>

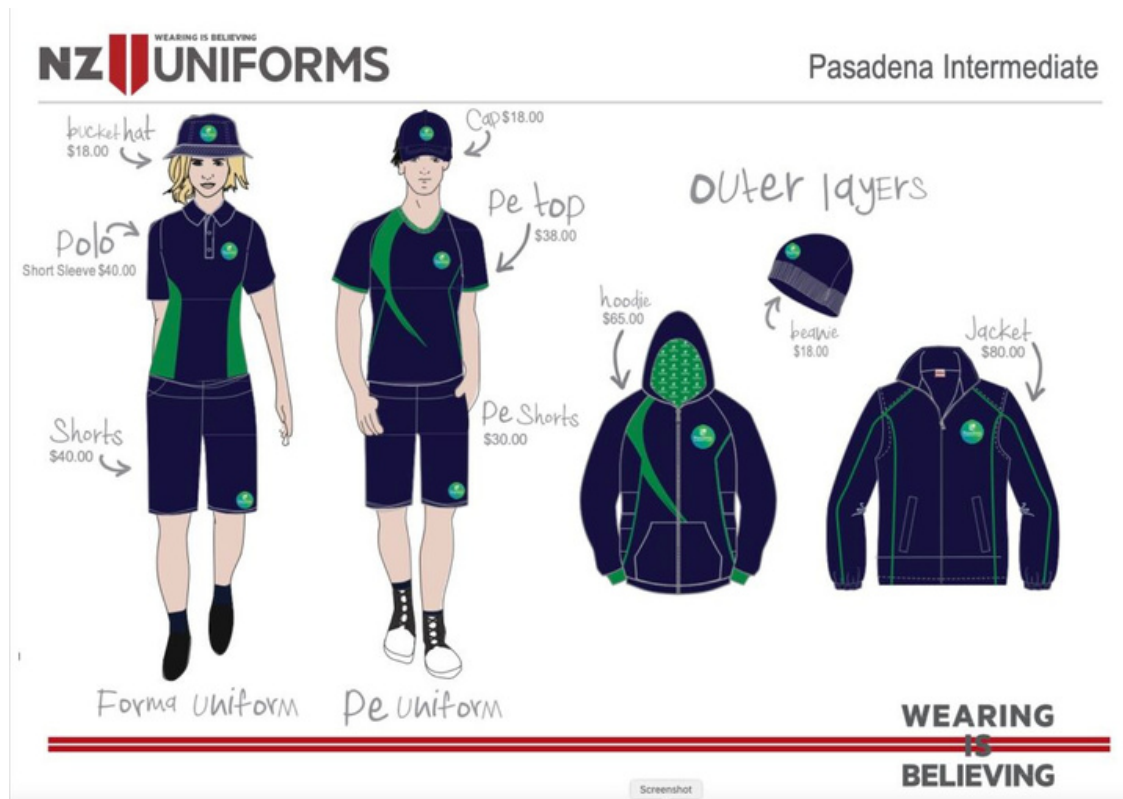

Formal Uniform

School Hoodie - \$65.00
 School Polo - \$40.00
 Shorts - \$40.00
 Trousers - (Orders required)
 Culottes - (Orders required)
 School Hat - Navy Blue Cap \$18.00 or Navy Blue Full Brimmed Bucket Hat -\$18.00

PE Uniform

Dri-fit PE Shirt - \$38.00
 Dri-fit PE Shorts - \$30.00

Optional Winter Uniform

Rain Jacket - \$80.00
 School Beanie \$18.00

The following items can be purchased from outside the uniform shop:

- Socks - White or black ankle length
- Shoes - Black; Lace-up (to be worn with socks)
- Sandals - Black or Brown with heel strap (to be worn without socks)

All students need to wear the correct uniform, no other items are allowed. The school uniform is unisex. Please ensure all uniform items are clearly named.

SCHOOL PROCEDURES

Absence

Parents must notify the school office before 8.45am by telephone 09 846-2169, text 0274688003, via the Hero app, or email on office@pasadena.school.nz. An explanation for the absence must be included.

Lateness

Students should be in their class **before 8.45am** so that they are ready for learning and don't miss important notices. If a student is late to school they must report to the office and sign in. Students will need to have a legitimate reason for being late. Ongoing lateness will be monitored by the Senior Leadership Team.

Incorrect Uniform

If, for any reason, students need to wear the incorrect uniform they must bring a note from their parents/caregivers and get a uniform pass from the Deputy Principal - Mary Pretorius, or Associate Principal - Christine Abercrombie.

Lost Property

Lost Property is located in the school office. If the item is named, students will be notified. It is essential that all uniform items, drink bottles and lunch boxes are clearly names.

Homework

Students receive 30 minutes of homework per night. This can be completed over the week. Teachers will explain the procedures in detail at the start of the year.

Bikes and Scooters

Students who ride their bikes and scooters to school can lock them in the bike racks behind the school office. Please make sure they are locked at all times.

School Lunches

Lunches can be ordered using the website www.lunchonline.co.nz or from the school website before 9am.

School Office Hours

The School Office is open from 8.00am - 4.00pm. Uniform and stationery can be purchased during these times. The office is closed during term holidays.

Pastoral Care

Pastoral care is very important to us. In the first instance, contact your child's classroom teacher. Our Counsellor Rebecca Braggins, is available on Wednesdays and Thursdays, she can be contacted at wellbeing@pasadena.school.nz. Following this contact our Deputy Principal, Mary Pretorius via email mary@pasadena.school.nz, or Associate Principal, Christine Abercrombie at christine@pasadena.school.nz or phone the office on 8462169.



KEY SCHOOL CONTACTS

School Office: 09 8462169
School Email: office@pasadena.school.nz
School Mobile: 0274688003.
School Website: www.pasadena.school.nz

Principal: Jonathan Hughes
jhughes@pasadena.school.nz

Deputy Principal / SENCO: Mary Pretorius
mary@pasadena.school.nz

Associate Principal: Christine Abercrombie
christine@pasadena.school.nz

Administration Officer: Lucy Kirwan
lucy@pasadena.school.nz

School Receptionist: Lina Fuimaono
lina@pasadena.school.nz

Counsellor: Rebecca Braggins
wellbeing@pasadena.school.nz

Learning Support Teacher: Rebecca Somerville
rebecca@pasadena.school.nz

TEACHERS | KAIAKO

Room 3: Emma Cornwell
emma@pasadena.school.nz

Room 4: Marie Satele
marie@pasadena.school.nz

Room 5: Charlotte Asi-Marsters
charlotte@pasadena.school.nz

Room 6: Carly Honey
carly@pasadena.school.nz

Room 7: Talia Rissling
talia@pasadena.school.nz

Room 8: Ella Bartholomew
ella@pasadena.school.nz

Room 11: Keith Ward
keith@pasadena.school.nz

Room 12: Jerome Brown
jerome@pasadena.school.nz

Room 13: Amanda Kemp
amanda@pasadena.school.nz

Room 14: Darcy-Lee Mitchell
darcy-lee@pasadena.school.nz

Room 15: Alicia King
alicia@pasadena.school.nz

Room 16: Dylan Wiggill
dylan@pasadena.school.nz

Room 17: Te Aotaihi Ngata-Aerengamate
teaotaihi@pasadena.school.nz

Room 18: Keeghan Hei Hei
keeghan@pasadena.school.nz

Room 19: Piripi Cotter
piripi@pasadena.school.nz

Visual Arts: Sue Elliot
sue@pasadena.school.nz

Performing Arts: Adam Fresco
adam@pasadena.school.nz

Food Technology: Kelly Allington
kelly@pasadena.school.nz

Technology: Olivia Leeming
olivia@pasadena.school.nz

KEY DATES 2024

2024 TERM DATES

Term 1: Wednesday 31st January – Friday 12 April

Term 2: Monday 29 April to Friday 5 July

Term 3: Monday 22 July to Friday 27 September

Term 4: Monday 14 October – Tuesday 17th December

TERM ONE IMPORTANT DATES

Wednesday 31st January: First Day of School
Pōwhiri 8am in the School Hall, School Starts
9am

Tuesday 6th February: Waitangi Day

Thursday 8th February: Meet the Teacher Picnic
6pm - 8pm

Wednesday 21st February: Camp Parent
Information Evening 6.30pm

Friday 29th March - Tuesday 2nd April: Easter

Thursday 4th April: School Social 6.30pm -
8.00pm

**Wednesday 10th April (1pm - 8pm) & Thursday
11th April (1pm – 6pm):** Student Led Conferences
- school finishes 12.45pm both days

Friday 12th April: Last day of term, school
finishes at 2pm

School Holidays

Friday 12th April - Sunday 28 April

Monday 29th April: Start of Term 2



BRING YOUR OWN DEVICE

Security

Security of devices is important and strong systems have been developed for securing devices. Lockable storage is available. Devices will be safely and securely stored during recreational intervals and not used during these times.

Recommended Devices

Chromebooks - these are the most cost effective devices currently available that work seamlessly with Google Apps
Laptops - the range of laptop devices is vast and tends to be divided into PC and Mac machines.

iPads & Tablets - there are several variations of tablets available. We are a Google School, so access to Google Apps is a minimum requirement

Advantages of BYOD

- Students are more likely to continue learning outside of the school hours
- Students take good care of their own devices
- Students love technology, BYOD will engage, create enthusiasm and excitement about learning
- Students who are familiar with their own device will focus on learning rather than needing to log into shared devices
- Increased level of student agency and added responsibility for looking after their own device

BYOD

The Bring Your Own Device (BYOD) approach is popular across schools nationwide and allows students to use personal devices for curriculum related activities. As a result, **Pasadena is a BYOD school with the expectation that every student will bring a device from home to class every day.**

With the development of the new flexible learning spaces at Pasadena, the presence and availability of devices for each student in the classroom is becoming a necessity. With the introduction of the new Digital Curriculum, which our school is leading the way in the local area, technology and devices are being moulded into the everyday teaching programme.

At Pasadena we see the use of technological devices in class as the natural way to move forward and keep up in a tech-dependent world. There is a limited number of Chromebooks available for students to use in each classroom. Moving forward we feel that the BYOD programme enables the majority of students to work together using personal tools that they are already comfortable with.

Any questions, contact our Digital Leader, Keith Ward at keith@pasadena.school.nz



CAMP EDUCATION OUTSIDE THE CLASSROOM

Camp will take place next year in Term 1 between 11th - 15th March at Tui Ridge Park near Rotorua.

Tui Ridge Park is an awesome place for a school camp with a range of different adventure activities, great food and cosy accommodation with makes for an experience students will never forget!

While at camp, over 3 days, students stay in dorms and embark on exhilarating activities such as High Ropes, Mountain Biking, Giant Swing, Flying Fox, and Geocaching while building on valuable teamwork skills.

Camp is an awesome opportunity for students to consolidate relationships with staff and students, challenge themselves physically, mentally and socially, learn new skills and refine old ones as well as developing leadership skills.

The cost for camp will be approximately \$350, this will be confirmed in mid February.

There will be a Camp Parent Information Night on Wednesday 21st February at 6.30pm where more information will be discussed and there will be an opportunity to ask any questions you may have.



OVERSEAS TRIPS 2024

At the start of the year we will explain the application process for the trips below.

VANUATU - SOCIAL ACTION ECO TRIP

This eco-adventure trip will provide an opportunity for a small group of students to take social action and connect with local schools in Vanuatu. Students will explore the islands learning more about Vanuatu's biodiversity, sustainability initiatives and wildlife. Activities include:

- Overnight stay at Hideaway Island Marine Reserve
- Ziplining through the jungle over canyons and waterfalls
- Coongoola Day trip- visit a turtle sanctuary, snorkel and swim on the waterways
- A jungle walk to Mele Cascades Waterfall
- Visit Ekasup Village to learn more about Vanuatuan culture
- Connecting with two local schools

The trip will take place in August 2024.



HIROSHIMA JAPAN CULTURAL EXCHANGE

Pasadena Intermediate and Nagisa Hiroshima Junior High School have been involved in annual student exchanges for 25 years. Past exchanges have proved to be fantastic learning experiences for the students who have participated, many making lifelong friends. Students on this exchange will stay in a hotel during a stopover in Tokyo and will be hosted by a Japanese student's family in Hiroshima, having the opportunity to genuinely experience Japanese culture and hospitality. Later in the year, Pasadena will host students from Nagisa Hiroshima Senior and Junior High School where they will experience a similar exchange here, staying with our students. Activities include:

- Tokyo for 2 nights where we go to Disneyland and Tokyo Tower
- Exchange with Nagisa Junior High School in Hiroshima where students stay with their host family. During this stay they will attend their host student's class and participate in PE, Music, Science, Art, Maths and English lessons, attend Japanese classes such as Flower Arranging and participate in excursions to places of interest in the region of Hiroshima

The Japan Cultural Exchange will take place in June/July 2024.



SCHOOL LUNCHES



Pasadena Intermediate Lunches are back!

Ciao Belli- Pasta/Pizza- Mon & Wed

Bon Sushi – Tuesdays

Burger Fuel – Thursdays

Pita Pit - Fridays

It's simple; all you need to do is register at

www.lunchonline.co.nz

and follow 4 easy steps to get started

- 1. Register an account**
- 2. Add member/s including your name and delivery location**
- 3. Make a payment to have funds in your account before you order**
- 4. Select your lunch and place an order**

Phone 0800 LOL LOL

Phone 0800 565 565

info@lunchonline.co.nz

